

**PROJECT**  
MacDONALD DRIVE, LANSDOWNE  
**SITE INFORMATION**  
LOCATION: MacDONALD DRIVE, LANSDOWNE  
ZONE: LIGHT INDUSTRIAL (ML)

**BASIC SITE STATISTICS (PROPOSED)**  
SITE AREA: 19,178.5 m<sup>2</sup>  
BUILDING AREA: 11.2 m<sup>2</sup>  
PROPOSED GRANULAR PAVED AREA: 10,005 m<sup>2</sup>

**SITE STATISTICS (ZONING COMPLIANCE)**

Provision	Requirement	Proposed	Complies?
<b>Light Industrial (ML) – Section 7.1</b>			
Permitted Uses	• Various industrial uses	Transportation Depot	Yes
Lot Area (min)	485 m <sup>2</sup>	19,178.5 m <sup>2</sup>	Yes
Lot Frontage (min)	15 m	239.3	Yes
Front Yard (min)	7.5 m	7.5 m	Yes
Rear Yard (min)	7.5 m	7.5 m	Yes
Interior Yard (min)	3 m	3 m	Yes
Building Height (max)	12 m	12 m	Yes
Lot Coverage (max)	40%	0%	Yes
<b>General Provisions – Section 3</b>			
Landscaped Open Space (3.15.a)	In any zone, any portion of any minimum required yard which is not used for any other permitted purpose shall be devoted to landscaped open space.	To comply.	Yes
Setbacks (3.32.b)	Where any lot is adjacent to a waterbody or watercourse, any building, structure, campsite, agricultural use that includes the keeping of livestock, and septic disposal system shall be set back a minimum of 30 m from the high water mark.	10 m	No



**KEY PLAN  
NTS**

**LEGEND**

	PROPERTY LINE
	HIGH WATER LINE
	HIGH WATER 6m SETBACK
	HIGH WATER 10m SETBACK
	GRANULAR PAVEMENT
	PROPOSED SWALE
	REQUIRED YARD SETBACK
	FIRE ROUTE

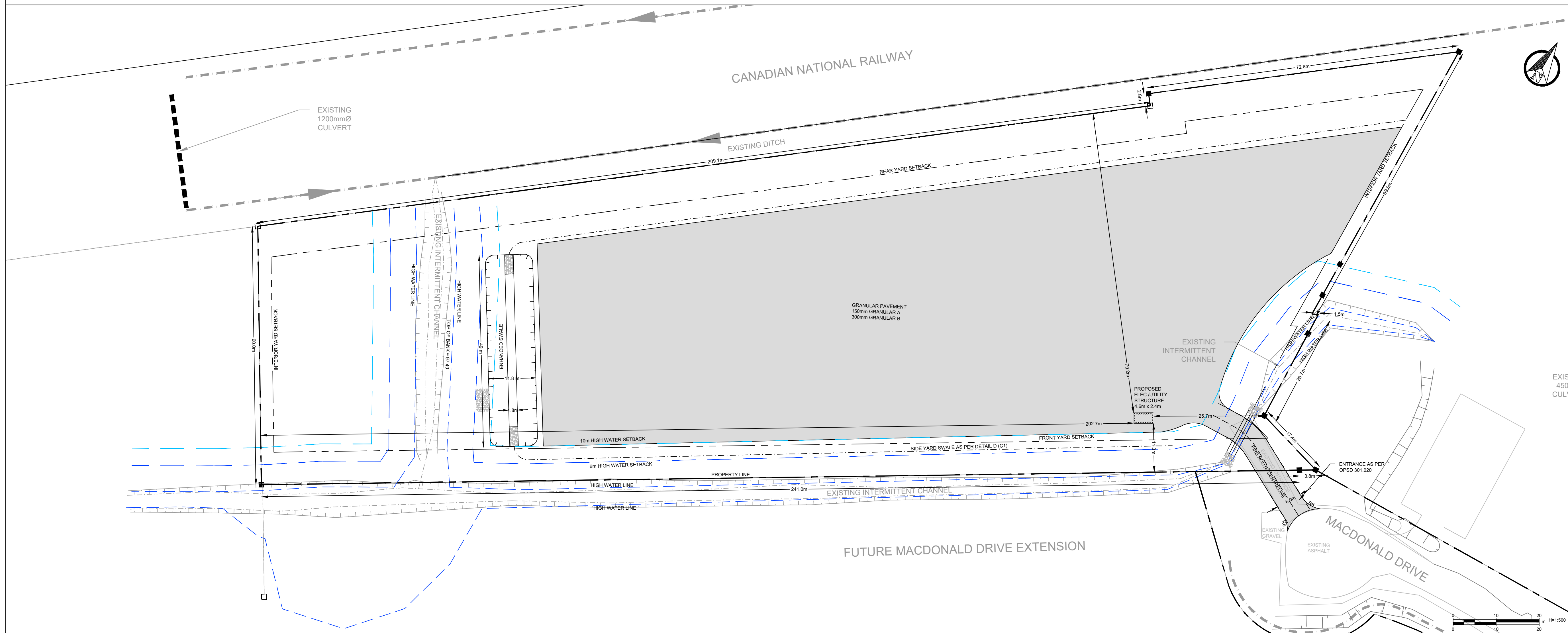

Benchmark		
No.	Revision/Issue	Date
1329 Gardiners Road, Suite 210 Kingston, ON, Canada K7P 0L8 613.634.9009 tel. 1.888.884.9392 fax.		
Client: <b>GOBOX PORTABLE STORAGE INC.</b>		
Project: <b>MacDONALD DRIVE LANSDOWNE</b>		
Drawing: <b>SITE PLAN</b>		
Drawn by: LAP	Checked by: JH	Project No.
Designed by: KMN	Approved by: KMN	Drawing No.
Date: NOVEMBER 2024		
Scale: 1:500 (ANSI D)		